



House-26/A, Nordda, Sarkar Bari.Gulshan-2

Web-[www.qcebd.com](http://www.qcebd.com)

Email: [qcebd2200@gmail.com](mailto:qcebd2200@gmail.com)

FB Page: [Qualitycontrolengineering](https://www.facebook.com/Qualitycontrolengineering)

Cell:01640910624-9

## ABOUT US

- **Quality Control Engineering now constitutes a full-service independent specialist Fire, Safety and Security services solution providers committed to meeting the needs of its customers for protection from fire and to keep them safe.**
- **Established in September 2016 and incorporating Quality Control Engineering.**
- **Quality Control Engineering prides itself as one of the leaders in fire-fighting and industrial safety equipment. We provide the latest Technology and equipment allowing us to give our customers the best services possible. We also do a follow up on all clients to ensure that all equipment supplied is efficiently running and serviced on time. We have grown out of the need of ensuring safety and professional guidance to the public for safer and proper Usage of all fire and industrial safety equipment**



House-26/A, Nordda, Sarkar Bari.Gulshan-2

Web-[www.qcebd.com](http://www.qcebd.com) Email: [qcebd2200@gmail.com](mailto:qcebd2200@gmail.com) FB Page: [www.facebook.com/qcebd2200](http://www.facebook.com/qcebd2200)

Cell:01640910624-9

## OUR SERVICES

### Fire Fighting System



### Detection System



### CCTV System



### PABX & Intercom System



### LPS System

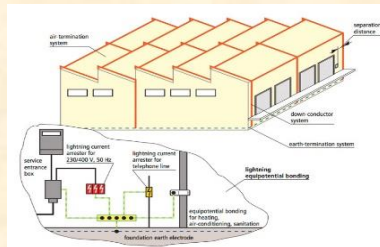

### Access Control System



### Electrical Solution

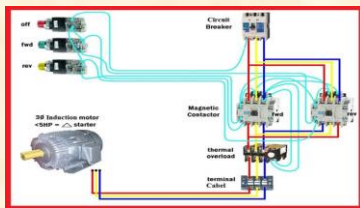

### PA System



### Consultancy



### Drawing & Design



### Safety Solution



### Mechanical Solution



### Deep-Tube Well Pump



### Commissioning



### Lighting Solution



House-26/A, Nordda, Sarkar Bari. Gulshan-2

Web: [www.qcebd.com](http://www.qcebd.com) Email: [qcebd2200@gmail.com](mailto:qcebd2200@gmail.com) FB Page: [www.facebook.com/qcebd2200](http://www.facebook.com/qcebd2200)

Cell: 01640910624-9





# FIRE PROTECTION SYSTEM

Electrical Motor with Pump →

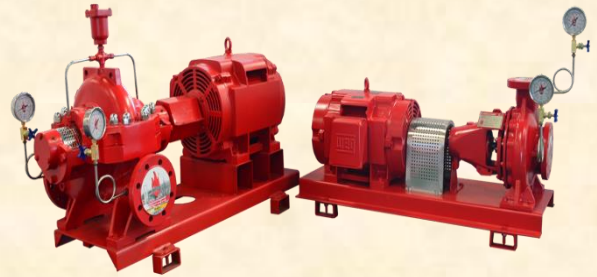

← Diesel Pump

Jockey Pump →

Fig.1 CVF





# FIRE DETECTION SYSTEM



← **ADDRESSABLE FIRE  
ALARM CONTROL  
PANEL**  
**ADDRESSABLE**



**SMOKE SENSOR** →



← **CONVENTIONAL  
SOUNDER**



**PULL STATION** →

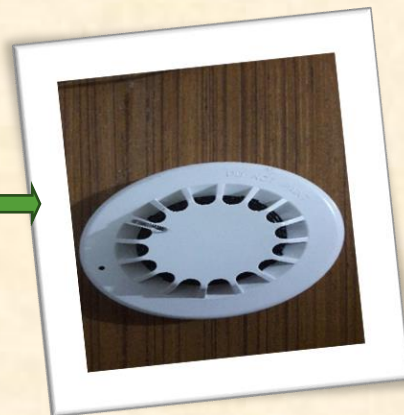

**ADDESSABLE HEAT DETECTOR** →



# CCTV SYSTEM

**DOM CAMERA**



**NETWORK CAMERA**



**IP CAMERA**



**DVR**



**HD CAMERA**



**MONITOR**





# PABX & INTERCOM SYSTEM

## TELEPHONE SET

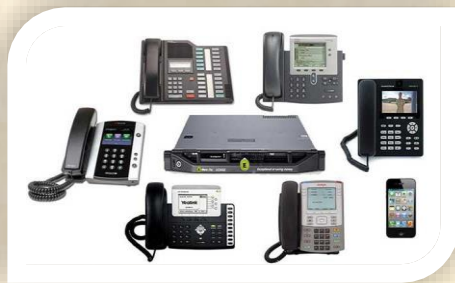

## PABX

## DVER SET



## VIDEO CALLING



House-26/A, Nordda, Sarkar Bari.Gulshan-2

Web-[www.qcebd.com](http://www.qcebd.com) Email: [qcebd2200@gmail.com](mailto:qcebd2200@gmail.com) FB Page: [www.facebook.com/qcebd2200](http://www.facebook.com/qcebd2200)

Cell:01640910624-9





# LPS SYSTEM



**Core joint**



**Copper Core**



**Earthling Pe**

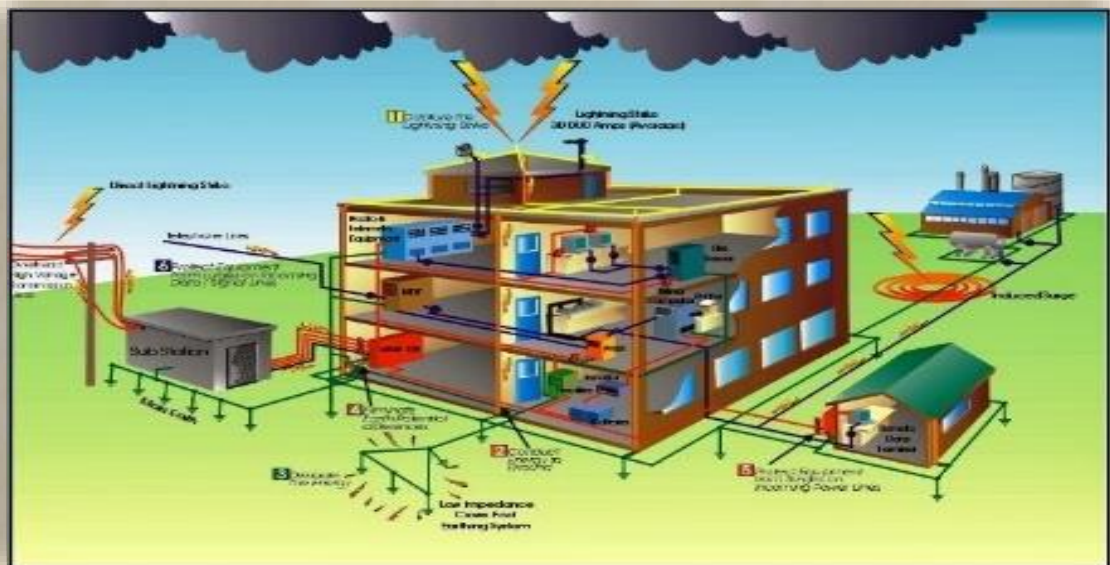





# ACCESS CONTROL SYSTEM



## Access Control with Time Attendance

### Finger Print



### Card Paunch system

## Time Attendance with Access Control





# ELECTRICAL SOLUTION



## BREAKER



## PLC CONTROL PANEL STAR-DELTA PANEL RELAY



## CONTROL PANEL



# PA SYSTEM



## SPEACKER



## AMPLIFIRE WITH SPEACKER



## MICROPHONE

## BOX TYPE SPEACKER



House-26/A, Nordda, Sarkar Bari.Gulshan-2

Web-[www.qcebd.com](http://www.qcebd.com) Email: [qcebd2200@gmail.com](mailto:qcebd2200@gmail.com) FB Page: [www.facebook.com/qcebd2200](http://www.facebook.com/qcebd2200)

Cell:01640910624-9





# CONSULTANCY



- **Job duties can vary depending on the industry in which a consultant is working and based on the specific field of expertise. Fixing or improving a particular component of client's business is the broadest duty for which consultants are hired.**
- **A consulting firm is a firm of experts providing professional advice to an organization or an individual for a fee. The primary purpose of a consulting firm is to provide access to industry - specific specialists and subject matter expertise. Consulting Services Chhattisgarh analyses the need carefully.**
- **The consultant's primary role is to assist your organization with certain areas of your inclusiveness work. While the consultant may act as an educator, a catalyst for deeper change, a resource, or a facilitator, the leadership of the process remains within your organization.**
- **Your role as an IT consultant will be to work in partnership with clients, advising them how to use information technology in order to meet their business objectives or overcome problems. You'll work to improve the structure and efficiency of IT systems in various organizations.**



# DRAWING & DESIGN



**Plans are a set of drawings or two-dimensional diagrams used to describe a place or object, or to communicate building or fabrication instructions. Usually plans are drawn or printed on paper, but they can take the form of a digital file.**

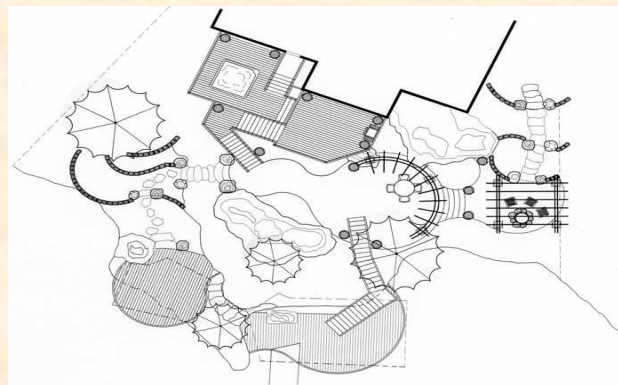



# SAFETY SOLUTION

**Fire Safety Plans are intended to assist the owner of a building with the basic essentials for the safety of all occupants, to ensure an orderly evacuation at the time of an emergency and to provide a maximum degree of flexibility to achieve the necessary fire safety for the building**







# MECHANICAL SOLUTION



**A mechanical fuel pump is driven by the camshaft, or by a special shaft driven by the crankshaft. As the shaft turns, a cam passes under a pivoted lever and forces it up at one end. ... When the lever pulls the diaphragm down, it creates suction that draws fuel along the fuel pipe into the pump through a one-way valve.**



# DEEP TUBE-WELL



**At the jet, the increase in water velocity creates the partial vacuum that draws standing well water into the second pipe and then back into the pump and plumbing system. Deep-well jet pumps use both the suction at the jet to bring water into the system and pressure applied by the impeller to lift the water.**







# PUMP COMMISSIONING

A high percentage of pumps are commissioned and then improperly started. This can result in damages or unit production interruptions. Pump maintenance and repair can be costly, which makes pump pre-commissioning, commissioning and startup crucial in today's industry.



House-26/A, Nordda, Sarkar Bari.Gulshan-2

Web-[www.gcebd.com](http://www.gcebd.com) Email: [gcebd2200@gmail.com](mailto:gcebd2200@gmail.com) FB Page: [www.facebook.com/gcebd2200](http://www.facebook.com/gcebd2200)

Cell:01640910624-9





# LIGHTING SOLUTION



**A light-emitting diode (LED) is a two-lead semiconductor light source. It is a p-n junction diode that emits light when activated. When a suitable current is applied to the leads, electrons are able to recombine with electron holes within the device, releasing energy in the form of photons.**

**Energy Efficient. LED lights are up to 80% more efficient than traditional lighting such as fluorescent and incandescent lights. 95% of the energy in LEDs is converted into light and only 5% is wasted as heat. This is compared to fluorescent lights which convert 95% of energy to heat and only 5% into light.**

House-26/A, Nordda, Sarkar Bari.Gulshan-2

Web-[www.qcebd.com](http://www.qcebd.com) Email: [qcebd2200@gmail.com](mailto:qcebd2200@gmail.com) FB Page: [www.facebook.com/qcebd2200](http://www.facebook.com/qcebd2200)

Cell:01640910624-9



Dear Sir/Madam,

We hope this email finds you well.

**Quality Control Engineering** is one of the most trust-worthy leading information and communication technology companies in Bangladesh. Since its inception in 2016, the company is working with a mission to meet the consumer needs and aspiration in distributing high-quality products through maintaining a high level of customer satisfaction.

**Quality Control Engineering** confidently presents diversified and multi-focus products which include:-

<b>1. Fire Hydrant System</b>	<b>2. Fire Detection System</b>
<b>3. CCTV System</b>	<b>4. PABX &amp; Intercom system</b>
<b>5. LPS System</b>	<b>6. Access Control System</b>
<b>7. Electrical Solution</b>	<b>8. PA System</b>
<b>9. Consultancy</b>	<b>10. Drawing &amp; Design</b>
<b>11. Safety Solution</b>	<b>12. Mechanical Solution</b>
<b>13. Deep-Tube Well Pump</b>	<b>14. Commissioning</b>
<b>15. Lighting Solution</b>	<b>16. Electronics ( All Kind of AC, Freeze)</b>
<b>17. Interior Design</b>	<b>18. Civil Construction</b>
<b>19. Generator</b>	<b>20. Chiller</b>
<b>21. Lift</b>	<b>22. Boiler Accessories</b>
<b>23. All Kind of Pump Solution</b>	<b>24. All Kind of Panel Solution</b>

The expert team of marketing professionals and certified engineers ensures uncompromised customer service at both pre-sales and post-sales periods. Our distinguished valued clients include reputed companies from the Telecommunication, Pharmaceutical, Engineering, FMCG, Financial, Healthcare, Textile, Garments, and Transport sector.

**Quality Control Engineering** is leading office automation and Engineering solution provider. The company is having an expert team of technical persons consisting of graduates and diploma engineers. For our valued customers, we have a service helpline available on a 24/7 basis which ensures instant support.

Please don't be hesitating to contact me for further inquiry. We will be happy to provide our best to you all the time. We are ready to conduct the demonstration any time as per your kind schedule.

Thanking you in anticipation and hope to serve you honestly and sincerely for all the time to come.

**Best regards.**

**Shah Iftakhar Alam**

**Assistant Director Operation**

Mobile:-01610-910628/01640910624.

Email: [qcebd2200@gmail.com](mailto:qcebd2200@gmail.com) Web: [www.qcebd.com](http://www.qcebd.com)

House-26/A, Nordda, Sarkar Bari. Gulshan-2

Web-[www.qcebd.com](http://www.qcebd.com) Email: [qcebd2200@gmail.com](mailto:qcebd2200@gmail.com) FB Page: [www.facebook.com/qcebd2200](http://www.facebook.com/qcebd2200)

Cell:01640910624-9



# OUR CLIENT'S



## CUSTOMER



## Our Service Related Brand



House-26/A, Nordda, Sarkar Bari.Gulshan-2

Web-[www.gcebd.com](http://www.gcebd.com) Email: [gcebd2200@gmail.com](mailto:gcebd2200@gmail.com) FB Page: [www.facebook.com/gcebd2200](http://www.facebook.com/gcebd2200)

Cell:01640910624-9





## CONTACT INFORMATION



House-26/A, Nordda Sarkar Bari, Gulshan-2.

Web-[www.qcebd.com](http://www.qcebd.com)

Email: [qcebd2200@gmail.com](mailto:qcebd2200@gmail.com)

FB Page: [www.facebook.com/qcebd2200](http://www.facebook.com/qcebd2200)

Cell:-01640-910624-9

01610-910628